

LEGENDA MATERIÁLU:

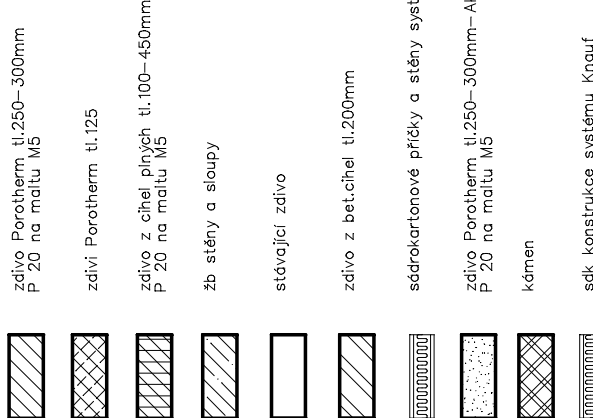

TABULKA MÍSTNOSTÍ

CSLO	INSTR	ACQUIS	CONC	PROG/ACT	POINTE	STAGE
101	Pré-Admis	17, 19		Severe trauma	Severe trauma	Severe trauma
102				Severe trauma	Severe trauma	Severe trauma
103	Severe trauma	18, 24		Severe trauma	Severe trauma	Severe trauma
104	Severe trauma	18, 24		Severe trauma	Severe trauma	Severe trauma
105	Severe trauma	18, 24		Severe trauma	Severe trauma	Severe trauma
106	Severe trauma	18, 24		Severe trauma	Severe trauma	Severe trauma
107	Severe trauma	18, 24		Severe trauma	Severe trauma	Severe trauma
108	Severe trauma	18, 24		Severe trauma	Severe trauma	Severe trauma
109	Severe trauma	18, 24		Severe trauma	Severe trauma	Severe trauma
110	Severe trauma	18, 24		Severe trauma	Severe trauma	Severe trauma
111	Severe trauma	18, 24		Severe trauma	Severe trauma	Severe trauma
112	Severe trauma	18, 24		Severe trauma	Severe trauma	Severe trauma
113	Severe trauma	18, 24		Severe trauma	Severe trauma	Severe trauma
114	Severe trauma	18, 24		Severe trauma	Severe trauma	Severe trauma
115	Severe trauma	18, 24		Severe trauma	Severe trauma	Severe trauma
116	Severe trauma	18, 24		Severe trauma	Severe trauma	Severe trauma
117	Severe trauma	18, 24		Severe trauma	Severe trauma	Severe trauma
118	Severe trauma	18, 24		Severe trauma	Severe trauma	Severe trauma
119	Severe trauma	18, 24		Severe trauma	Severe trauma	Severe trauma
120	Severe trauma	18, 24		Severe trauma	Severe trauma	Severe trauma
121	Severe trauma	18, 24		Severe trauma	Severe trauma	Severe trauma
122	Severe trauma	18, 24		Severe trauma	Severe trauma	Severe trauma
123	Severe trauma	18, 24		Severe trauma	Severe trauma	Severe trauma
124	Severe trauma	18, 24		Severe trauma	Severe trauma	Severe trauma
125	Severe trauma	18, 24		Severe trauma	Severe trauma	Severe trauma
126	Severe trauma	18, 24		Severe trauma	Severe trauma	Severe trauma

Stavající schodiště - v případě možnosti provést odšlápní /u terasizskovce,.../ Jínek provést bet.stěnu,med.podestý aie krytiny chodbe /zistěbavě pvc,ker,dlažba,beton+stěna/.