

23-01	TYPICKÝ POKOJ A1.25	1:40
23-02	TYPICKÁ KOUPELNA S VANOU A1.30	1:40
23-03	TYPICKÁ KOUPELNA SE SPRCHOU A1.31	1:40
23-04	TYPICKÁ KUCHYŇ A SPIŽ A1.32	1:40
23-05	TYPICKÁ OBÝVÁK A1.34	1:40
23-06	KANCELÁŘ A1.10	1:40
23-07	MASÉRNA A1.11	1:40
23-08	VÍŘIVKA A1.13	1:40
23-09	KUCHYŇKA U KANCELÁŘE A1.14	1:40
23-10	VYŠETŘOVNA A1.12	1:40
23-11	BEZBARIÉROVÉ WC A1.22	1:40
23-12	TYPICKÁ ŠATNA A1.21	1:40
23-13	KUCHYŇKA U DENNÍ MÍSTNOSTI A2.04	1:40
23-14	KOUPELNA A ŠATNA PERSONÁLU A2.07, A2.08	1:40
23-15	SKLAD GASTRO NÁDOB A1.23	1:40
23-16	TYPICKÝ VESTIBUL B1.02	1:40
23-17	TYPICKÝ SPÁROŘEZ BEDNĚNÍ STROPU VESTIBULU PRO POHLEDOVÝ BETON B1.02	1:40

±0,000 ≡ 286,800 m.n.m.

HLAVNÍ PROJEKTANT:



Energy Benefit Centre o.p.s.
Thákurova 531/4, 160 00 Praha 6
tel.: +420 270 003 300
e-mail: kontakt@energy-benefit.cz
internet: www.energy-benefit.cz

ZPRACOVATEL ČÁSTI:

Vypracoval:
Ing. arch. Andrej Kušnierik
Zodpovědný projektant:
Ing. Vladimír Fiedler



PROJEKT:

**Rozvoj komunitních sociálních služeb DOZP v lokalitě Jičín –
projektová dokumentace**

STAVEBNÍK:

KRÁLOVÉHRADECKÝ KRAJ
Pivovarské náměstí 1245, 500 03 Hradec Králové

ČÁST, PROFESE:

ARCHITEKTONICKÉ A STAVEBNĚ TECHNICKÉ ŘEŠENÍ

VÝKRES:

DETAILY TYPICKÝCH MÍSTNOSTÍ

razítko a podpis

Zakázkové číslo: Paré.

04-21-32

Datum:

30.01.2022

Část:

D.1.1

Stupeň:

DPS

Změna:

00

Č.výkr.:

23

Formát:

1 x A4

Měřítko:

1:40

TYPICKÝ POKOJ A1.25

STĚNA

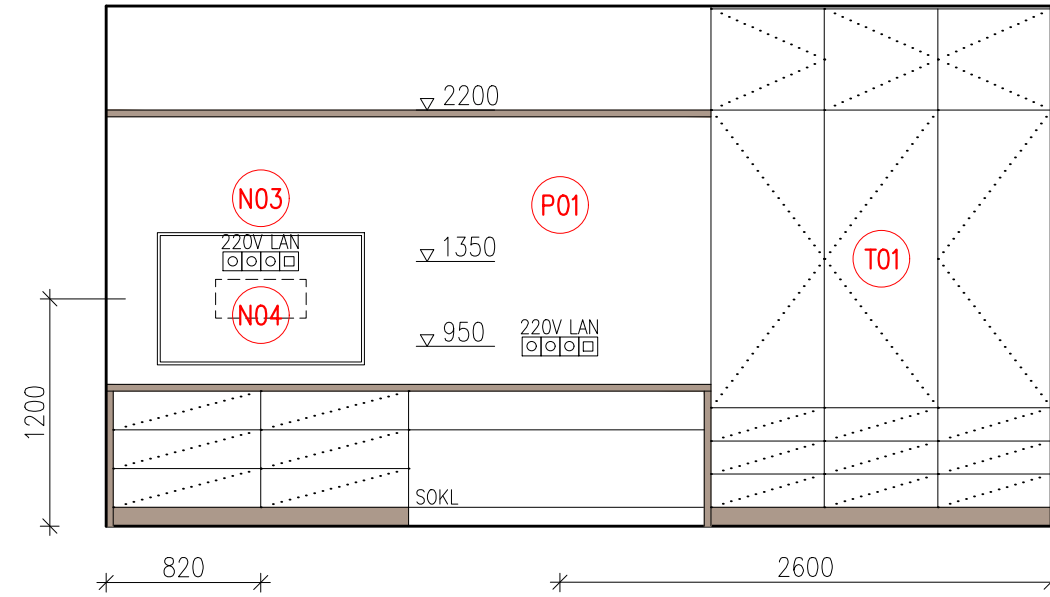

PODLAHA

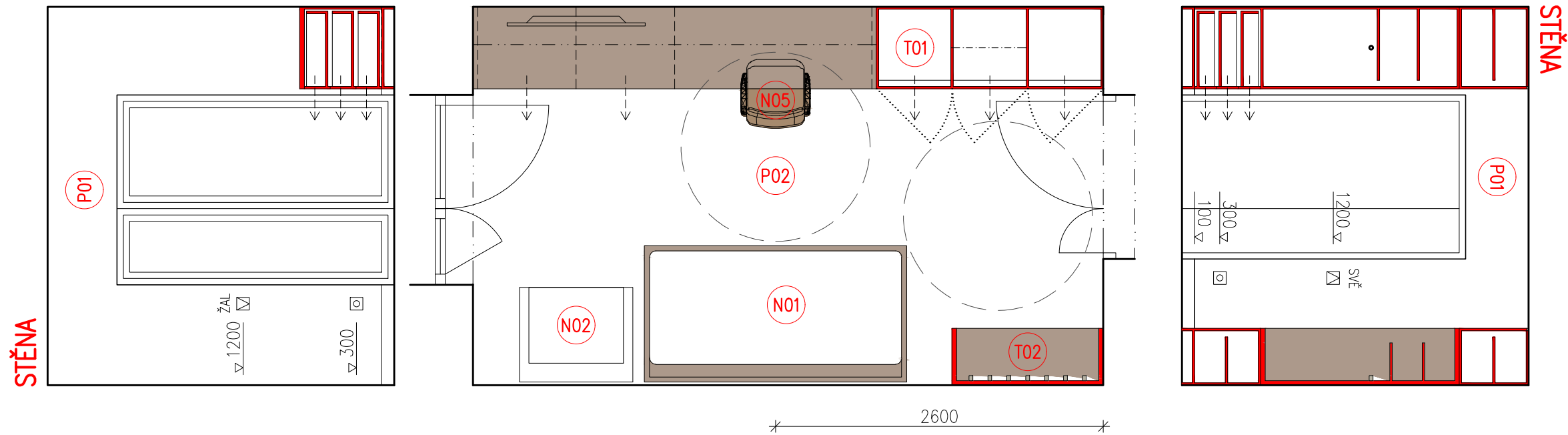

STĚNA

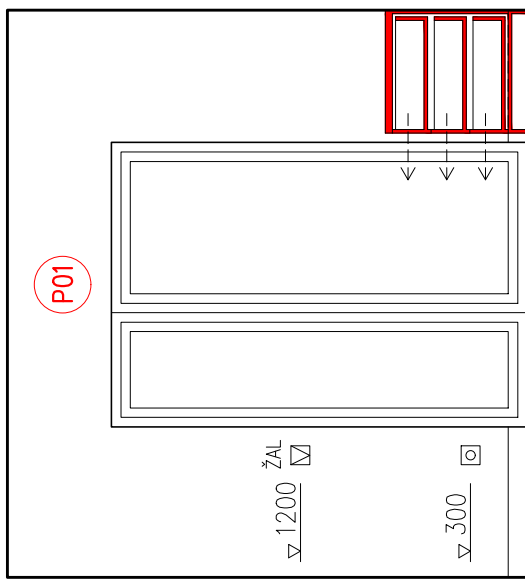

STĚNA

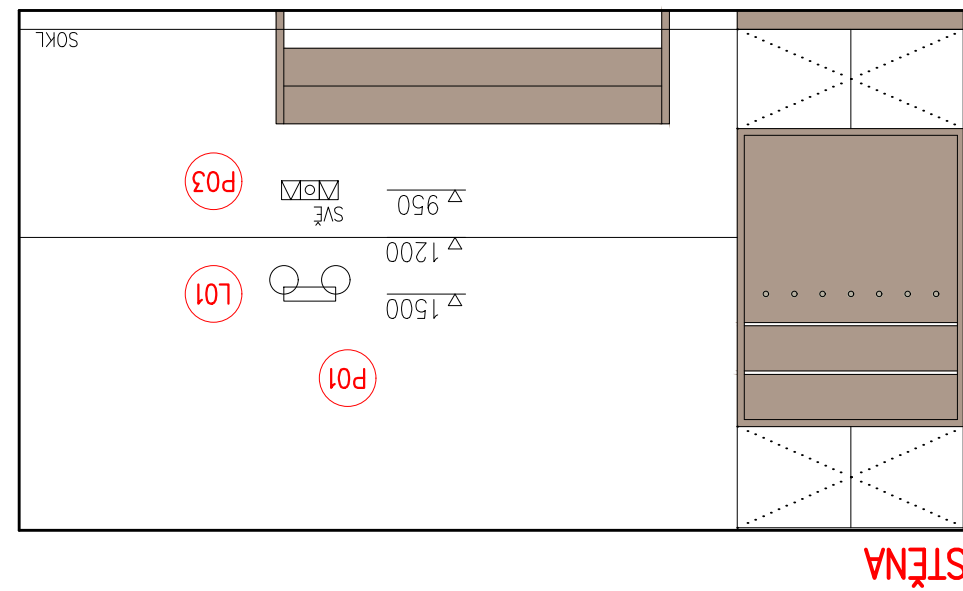
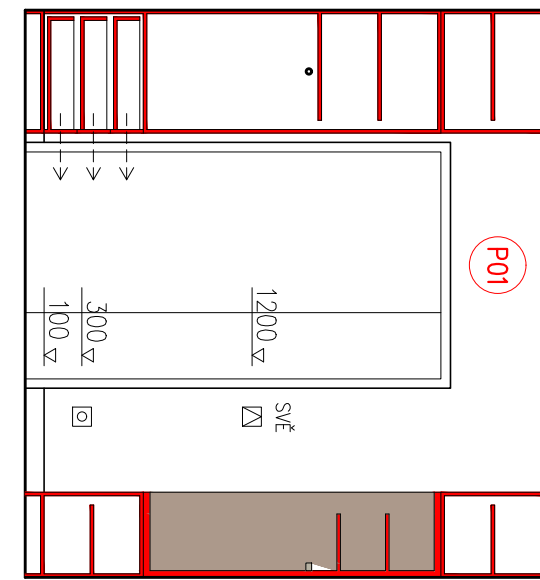

STĚNA

TYPICKÁ KOUPELNA S VANOU A1.30

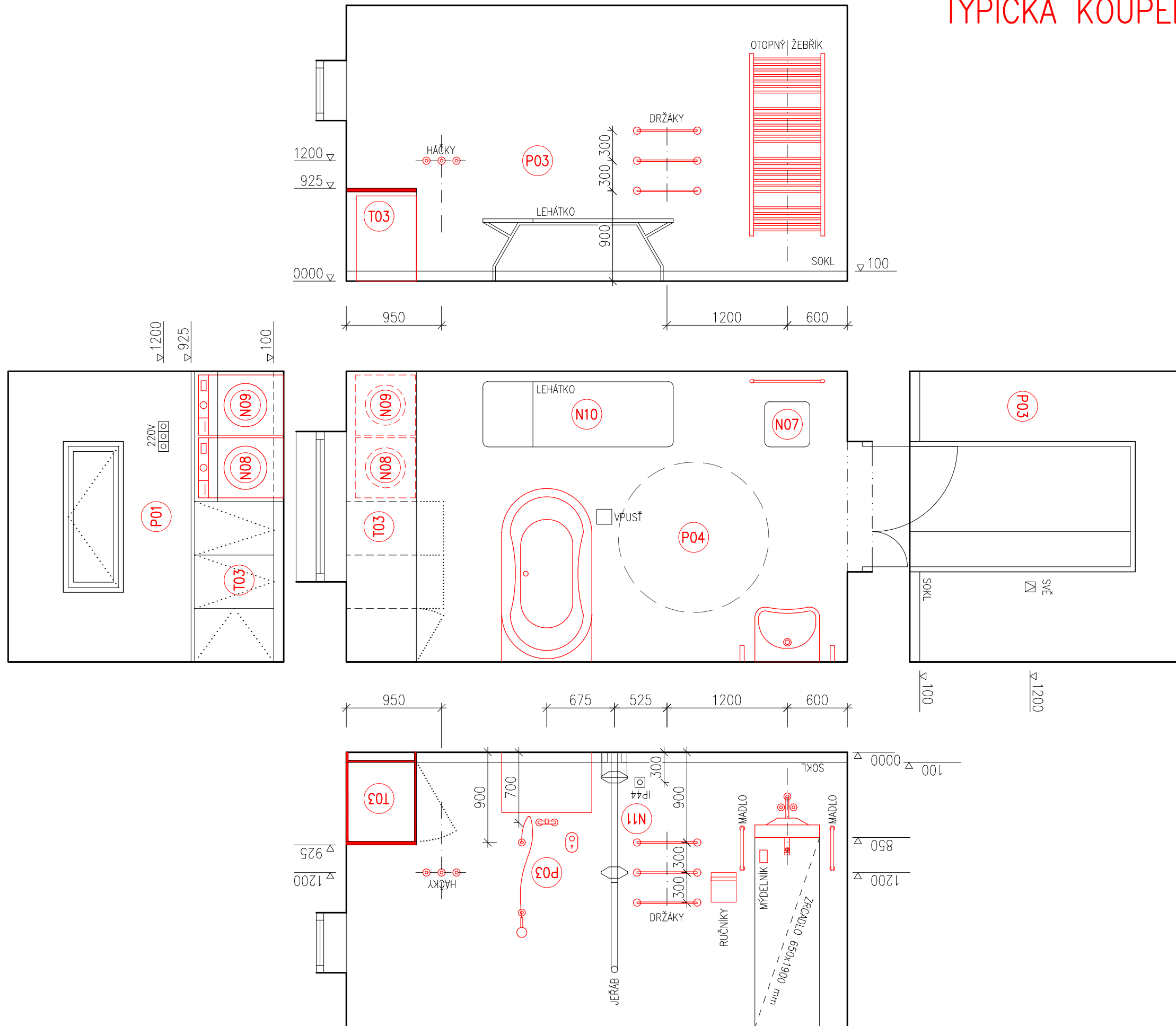

VÝKRES:
TYPICKÁ KOUPELNA S VANOU A1.30

Č.det. 23-02
Měřítko: 1:40

TYPICKÁ KOUPELNA SE SPRCHOU A1.31

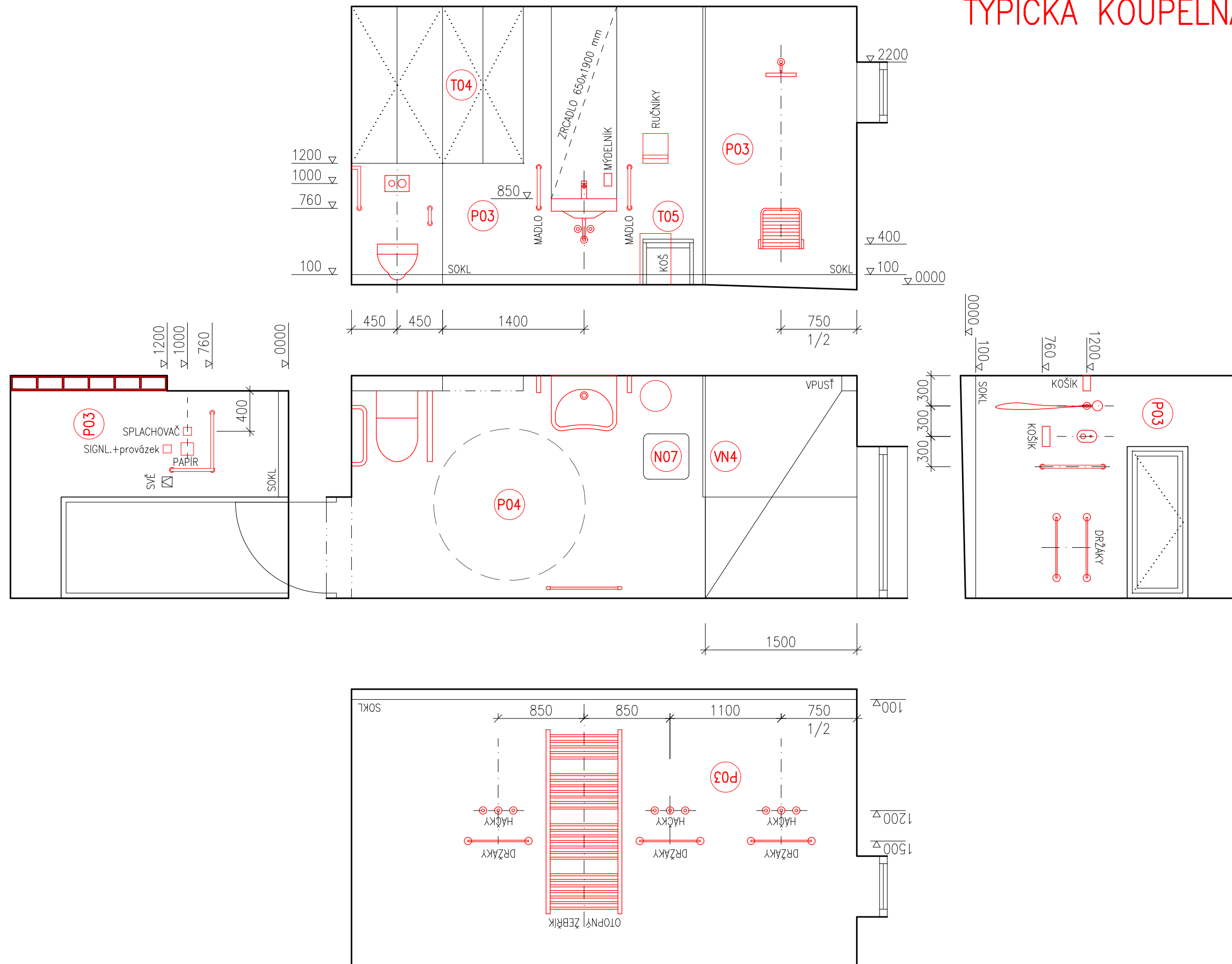

VÝKRES:
TYPICKÁ KOUPELNA SE SPRCHOU A1.31

Č.det. 23-03
Měřítko: 1:40

TYPICKÁ KUCHYŇ A SPIŽ A1.32

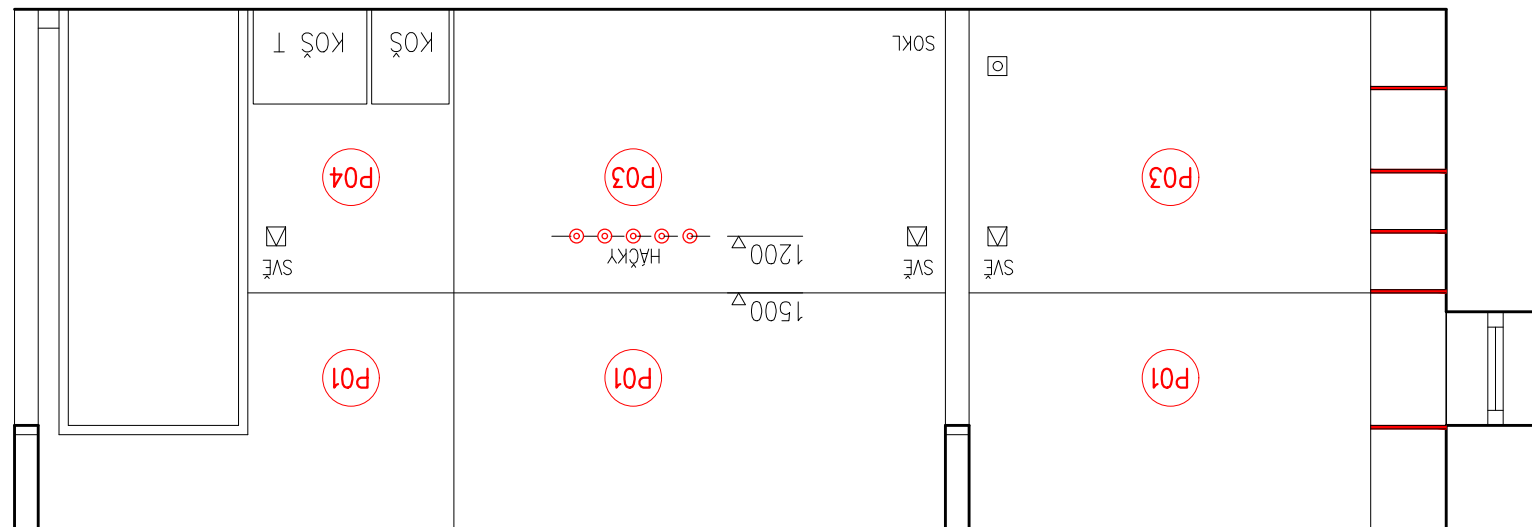
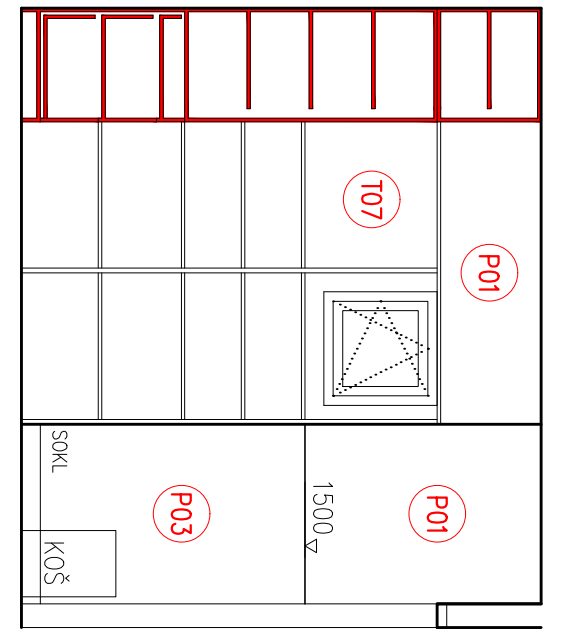
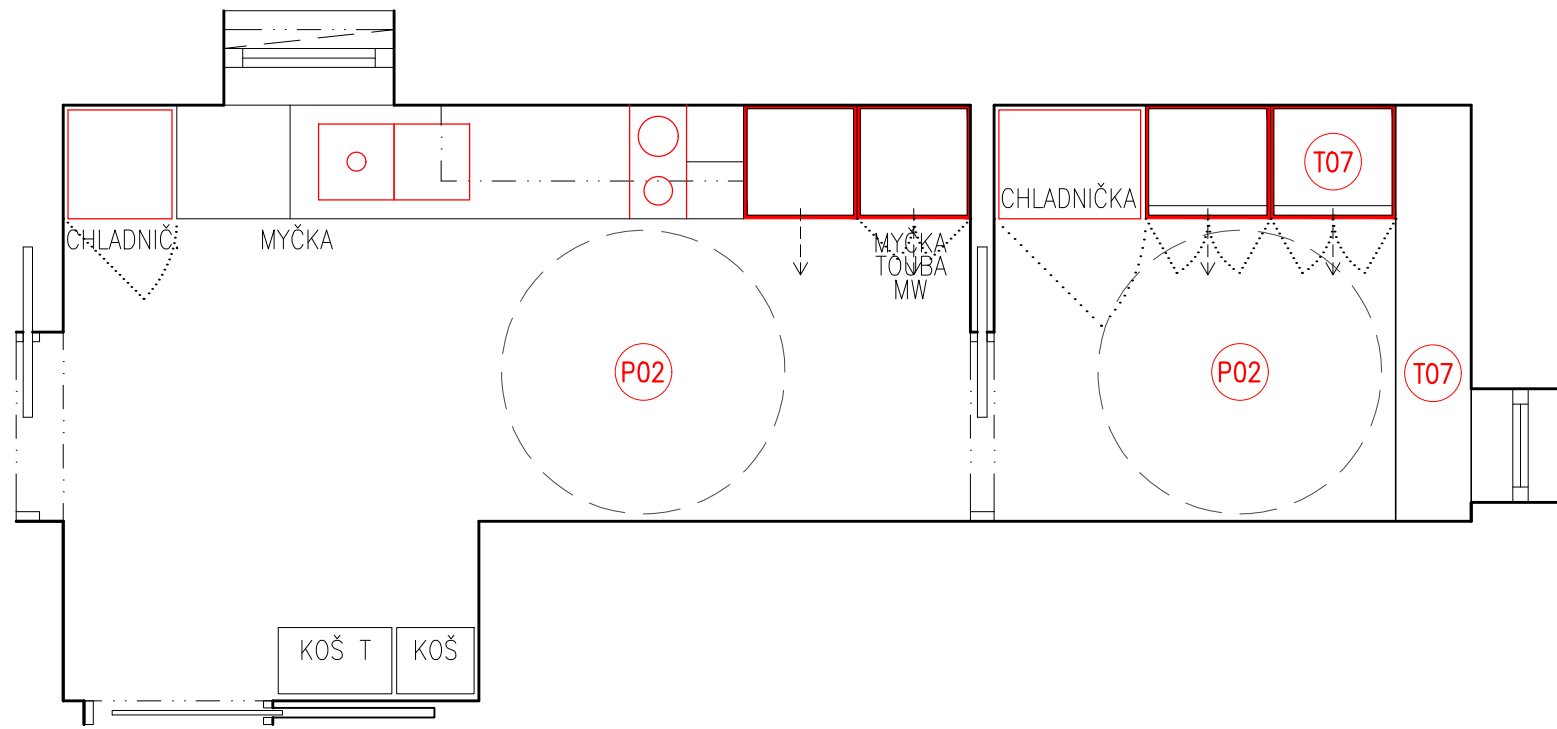
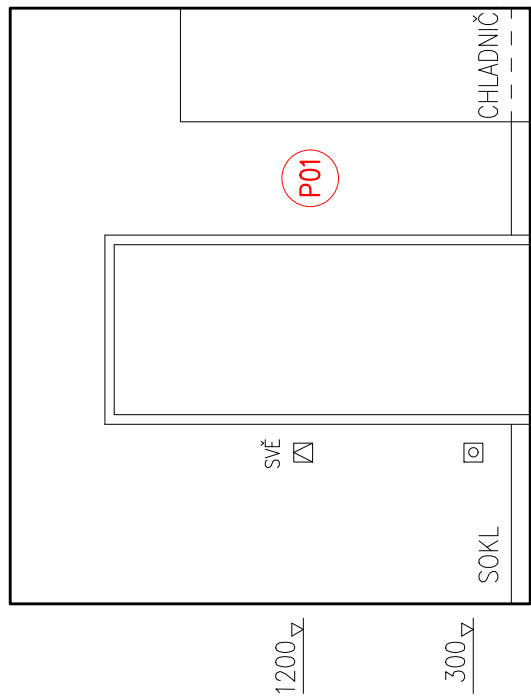
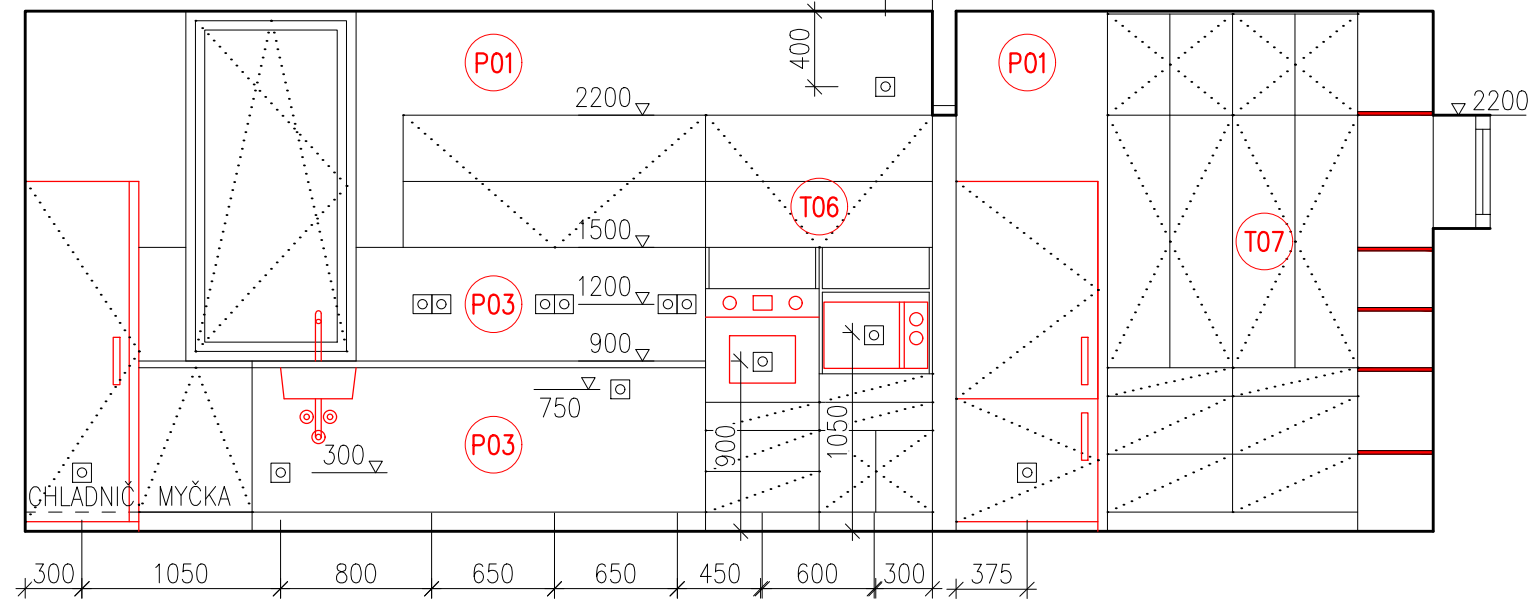

TYPICKÝ OBÝVÁK A1.34

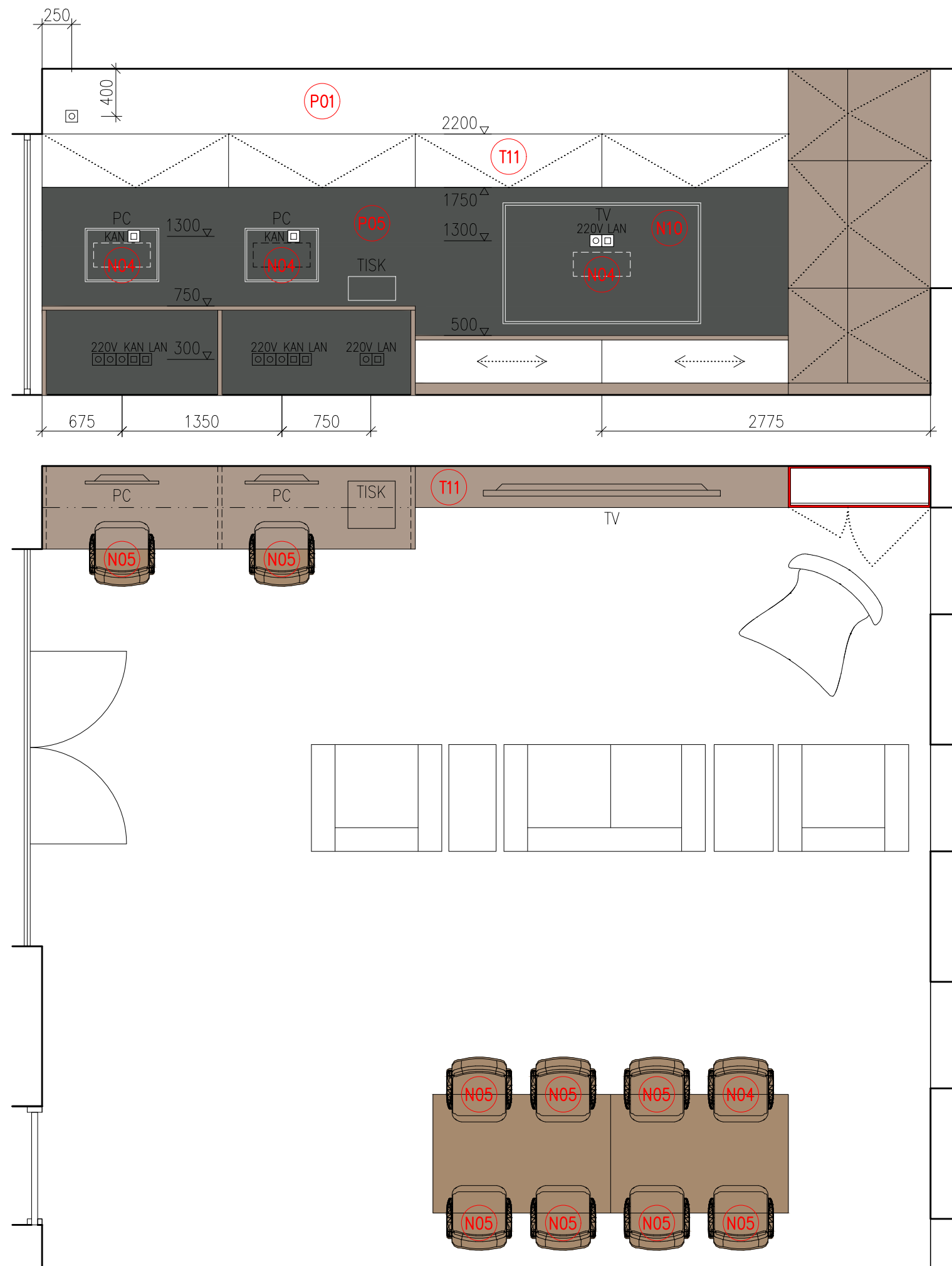

VÝKRES:
TYPICKÁ OBÝVÁK A1.34

KANCELÁŘ A.1.10

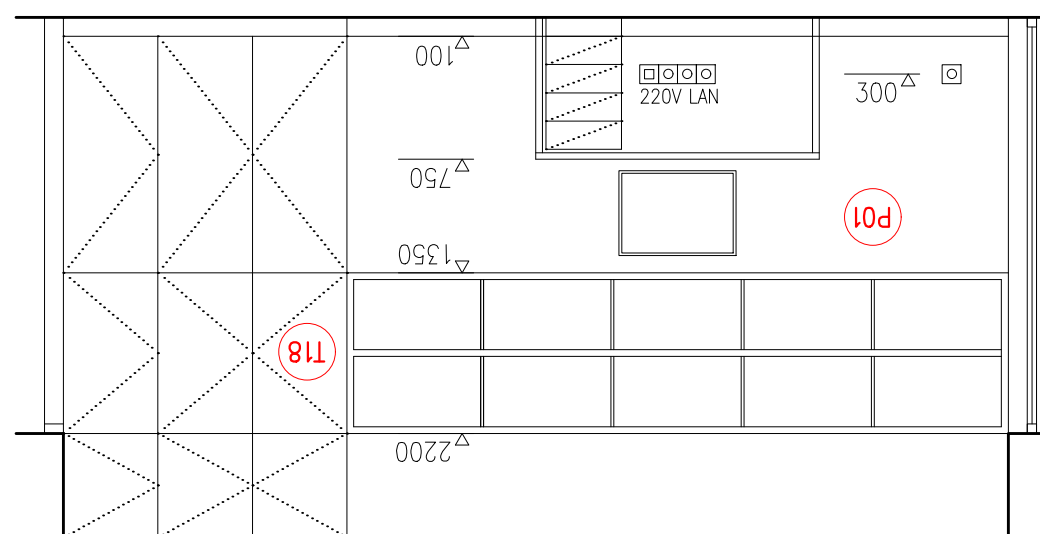
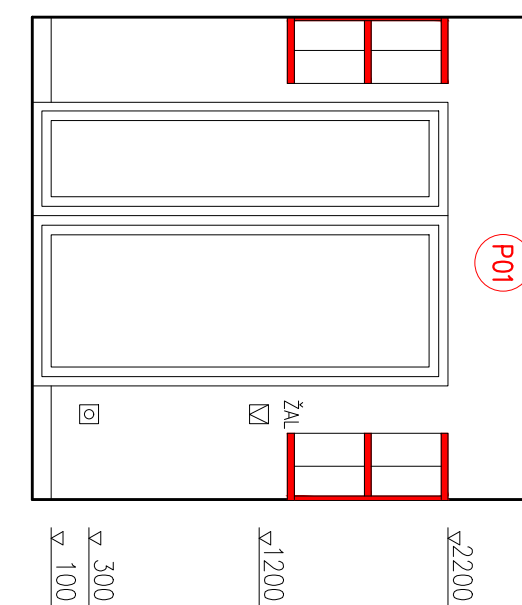
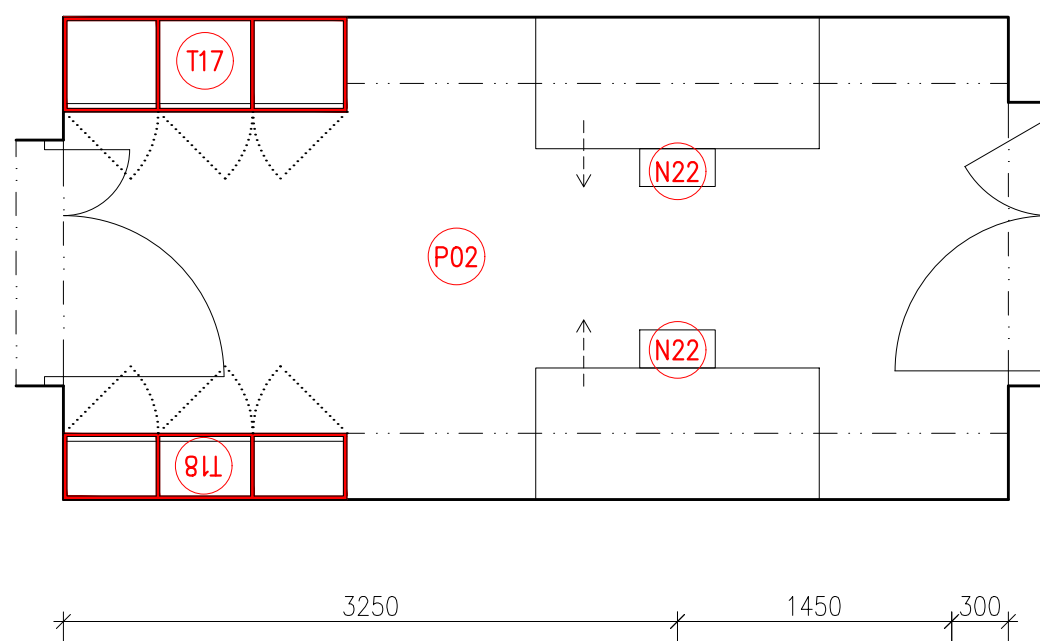
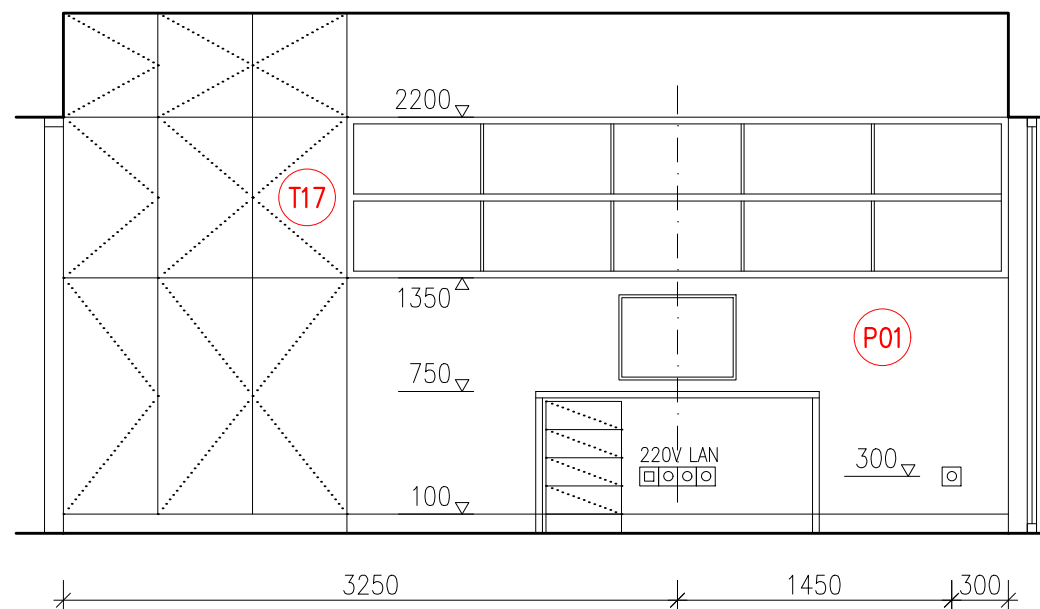
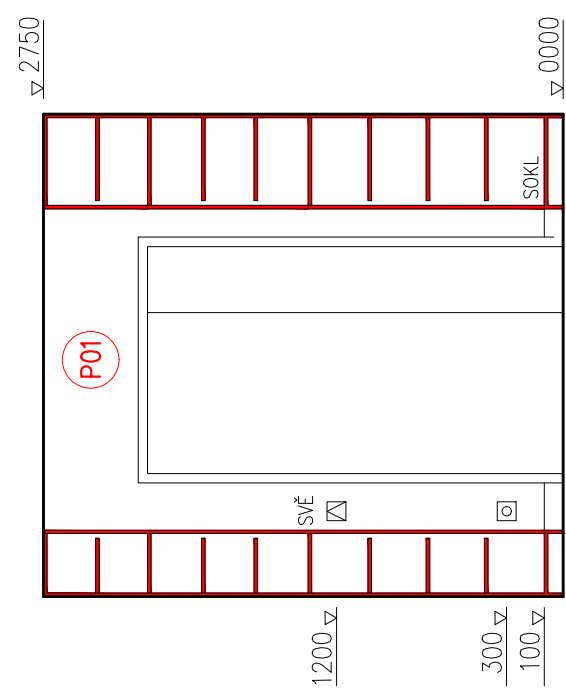

MASÉRNA A1.11

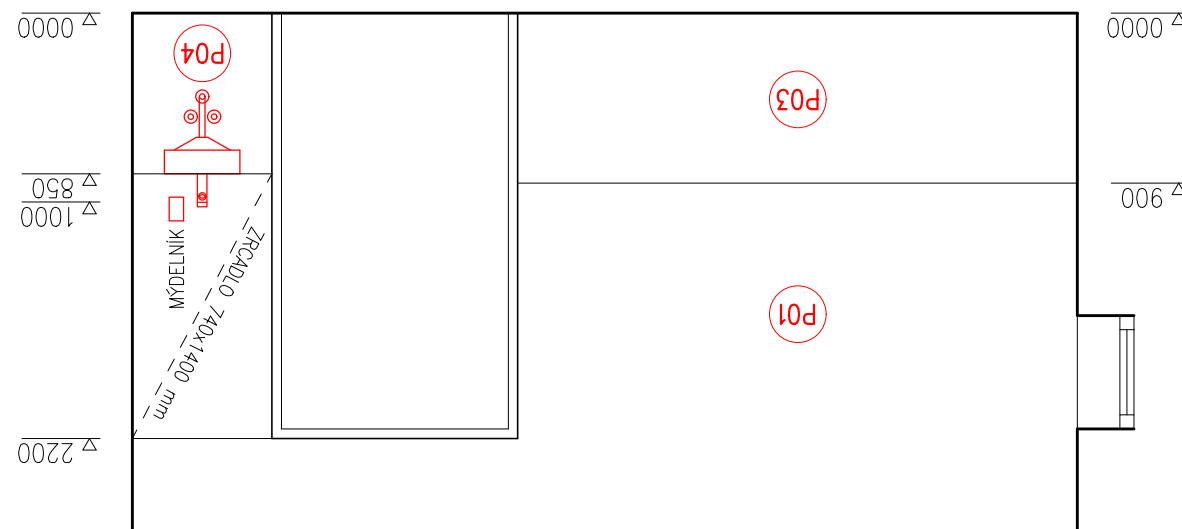
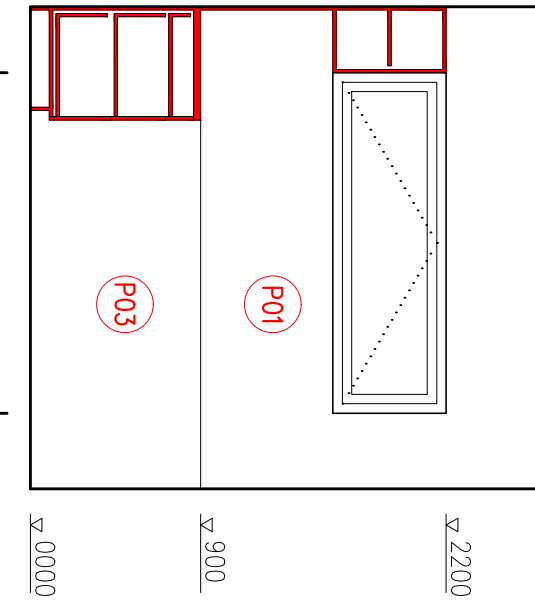
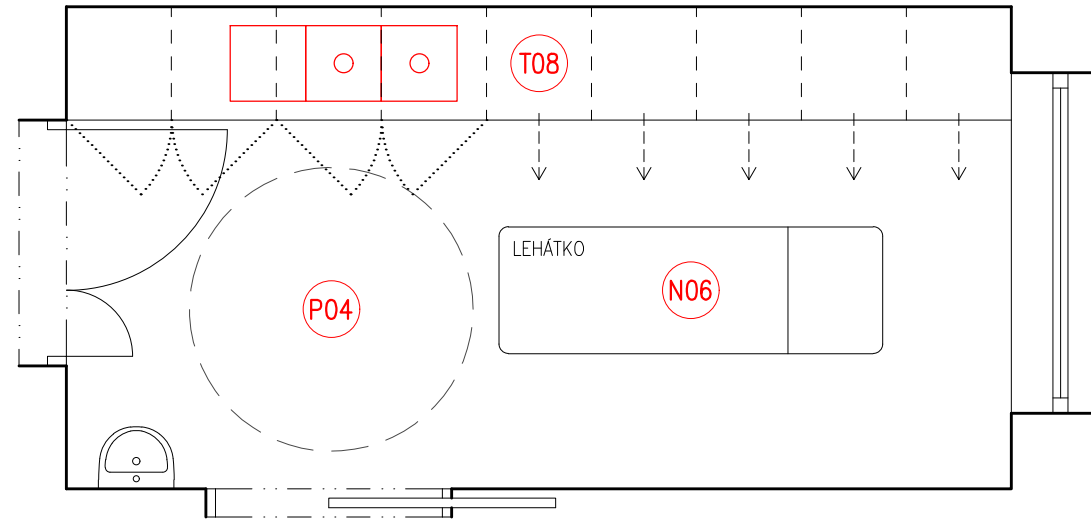
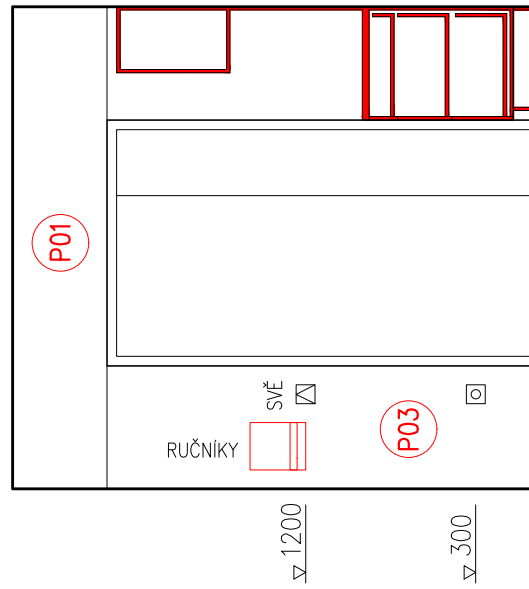
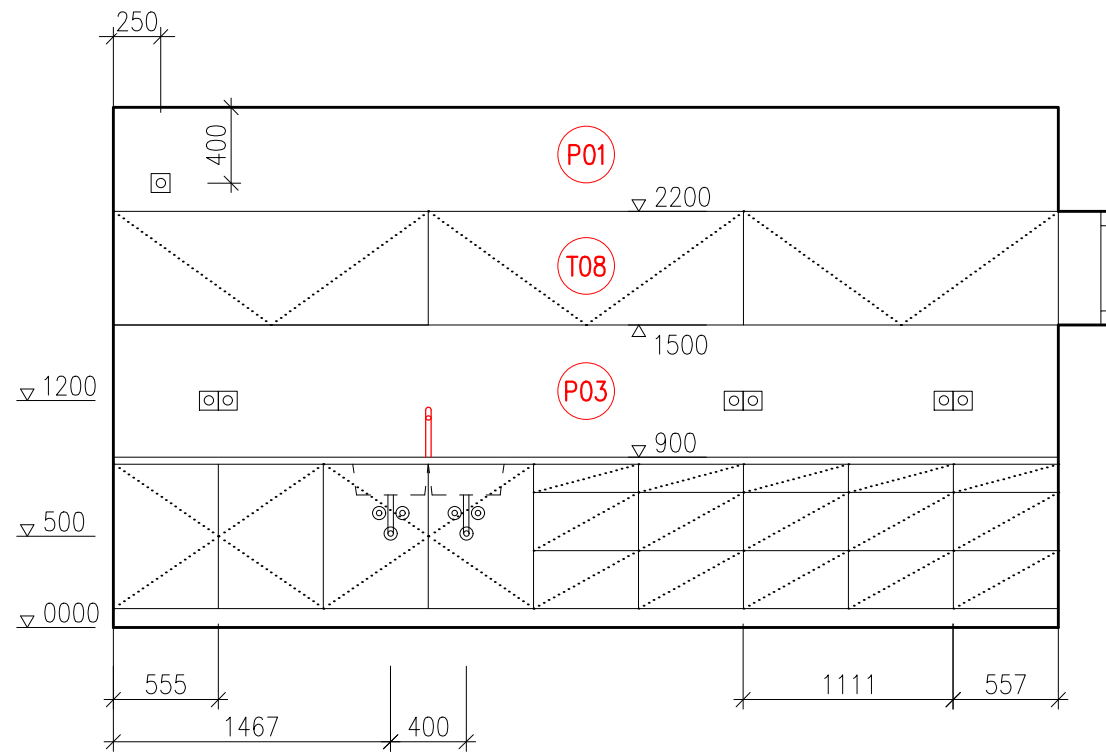

VÍŘIVKA A1.13

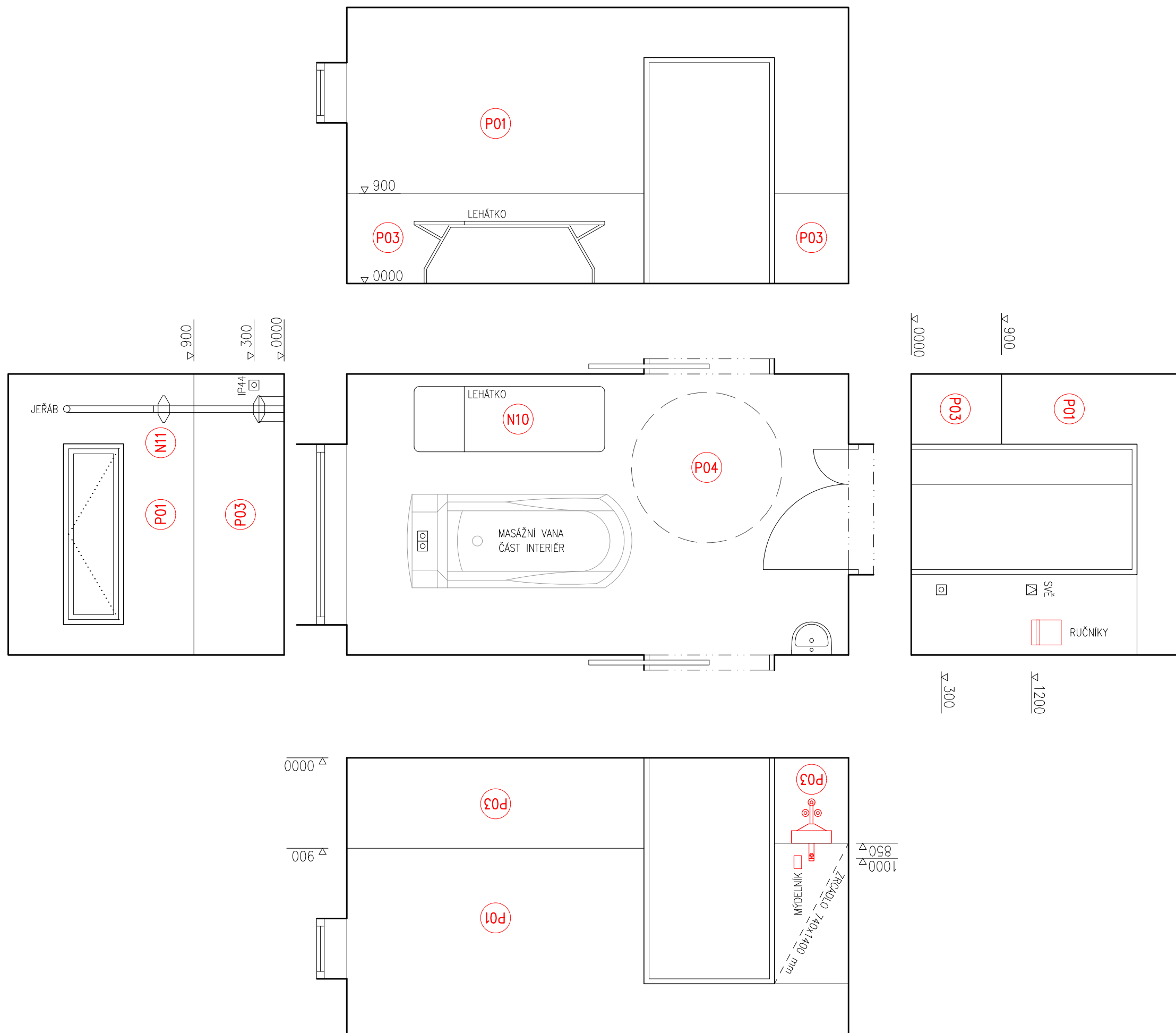

VÝKRES:
VÍŘIVKA A1.13

KUCHYŇKA U KANCELÁŘE A1.14

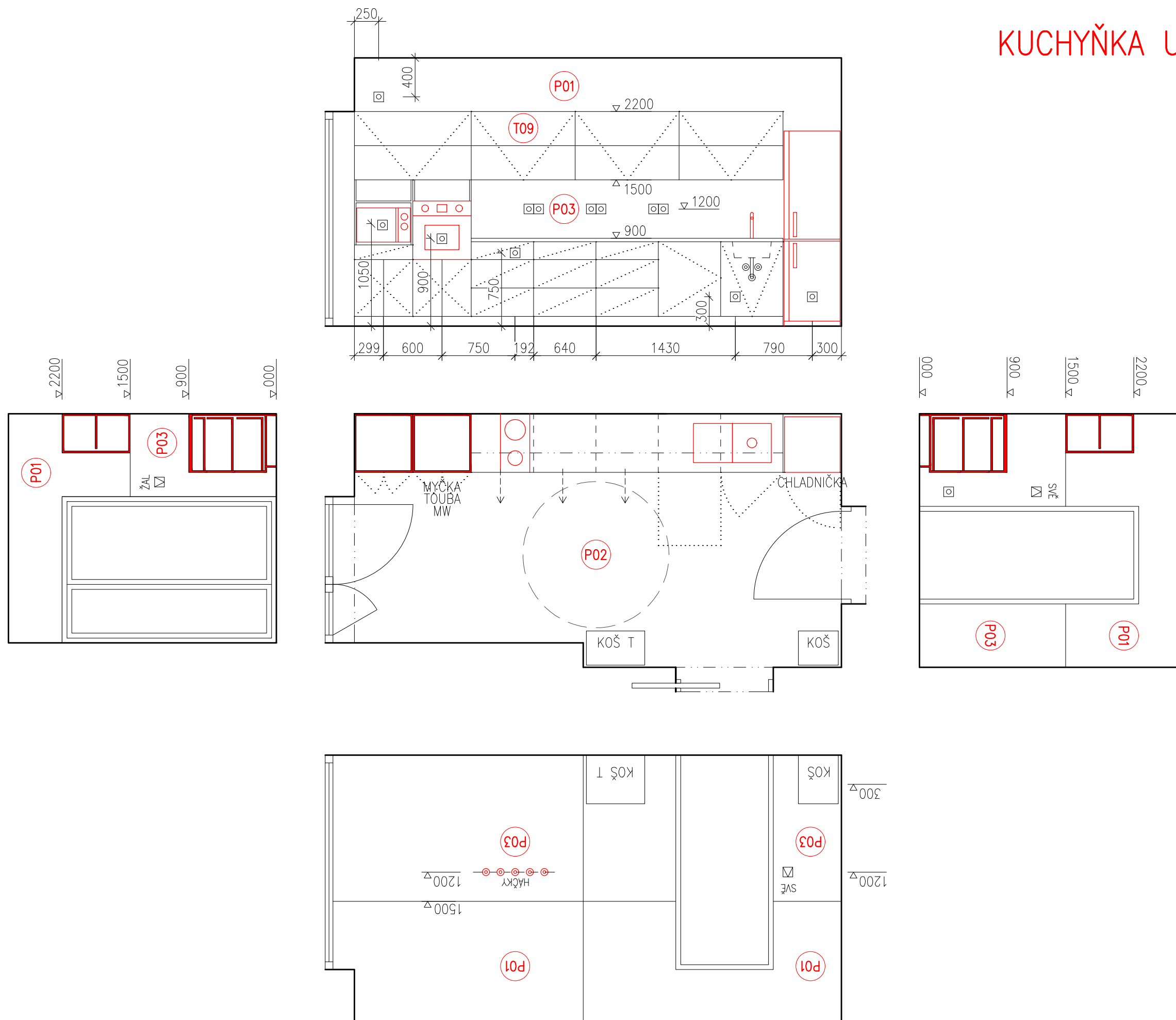

VYŠETŘOVNA A1.12

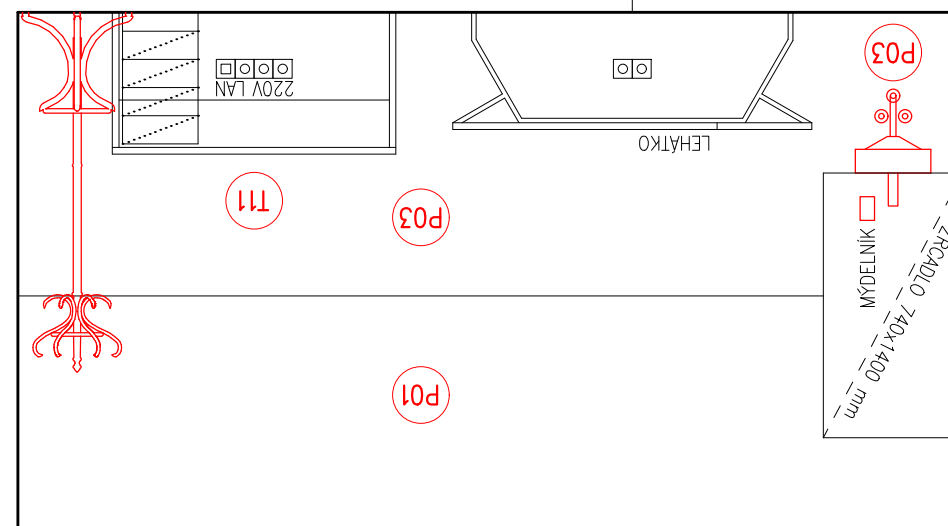
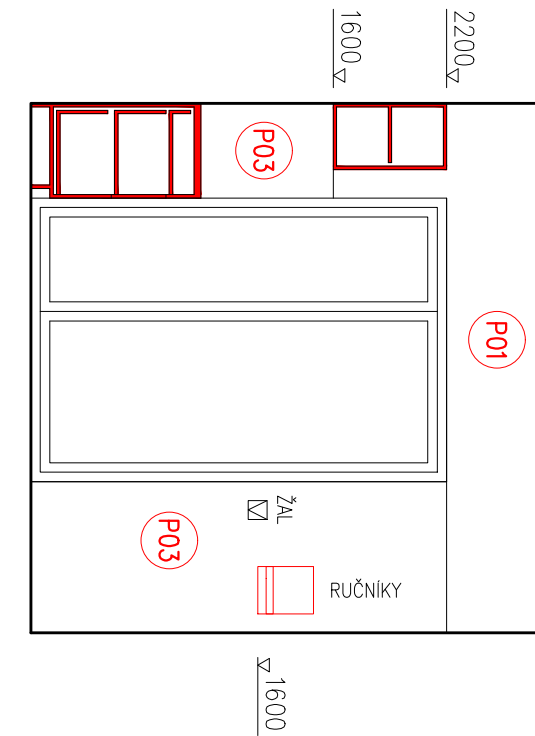
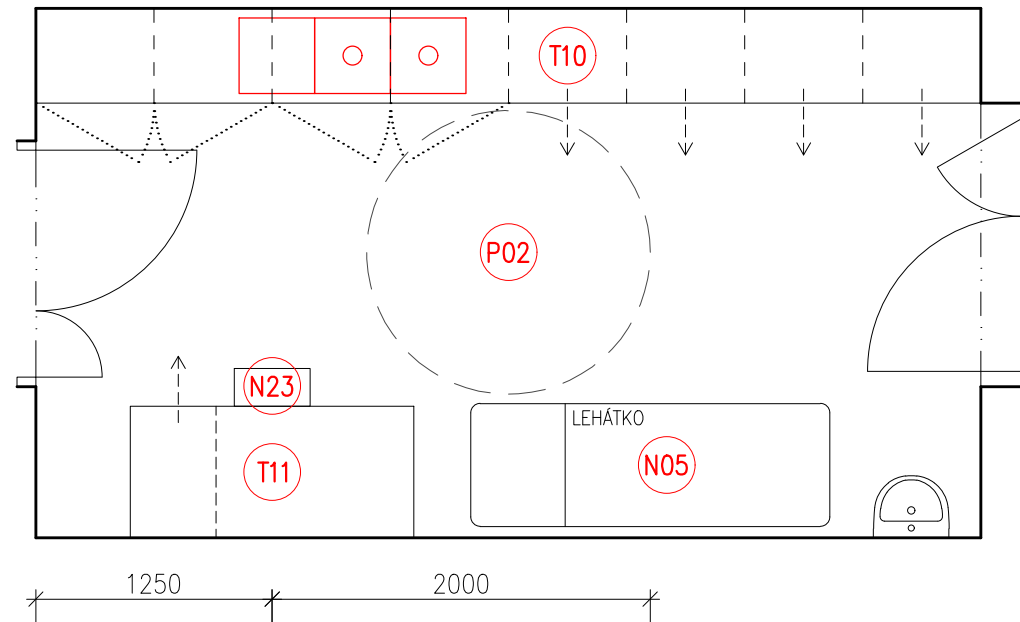
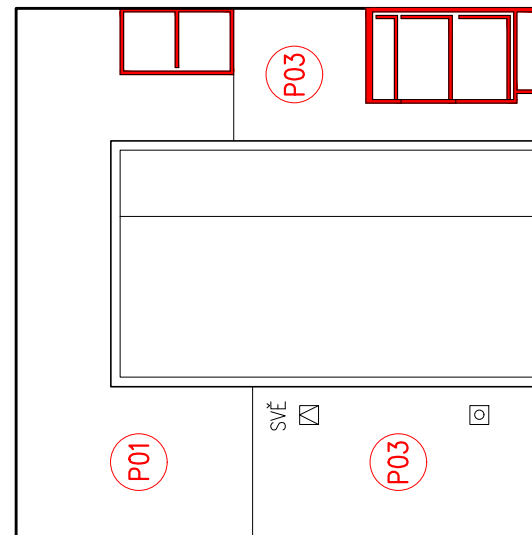
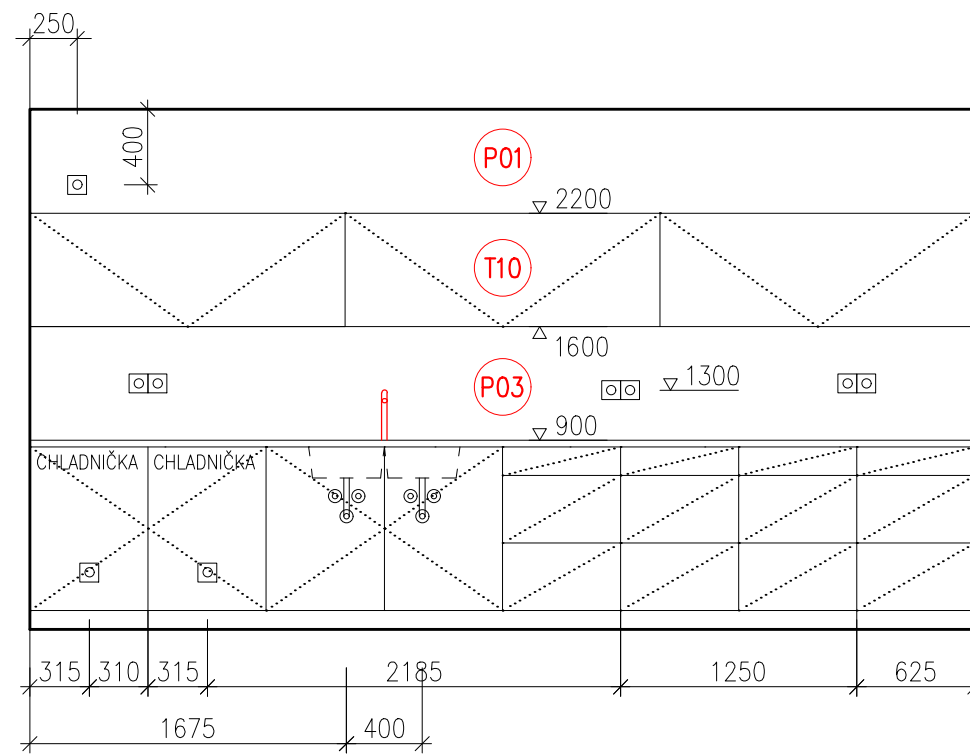

VÝKRES:
VYŠETŘOVNA A1.12

Č.det. 23-10
Měřítko: 1:40

BEZBARIÉROVÉ WC A1.22

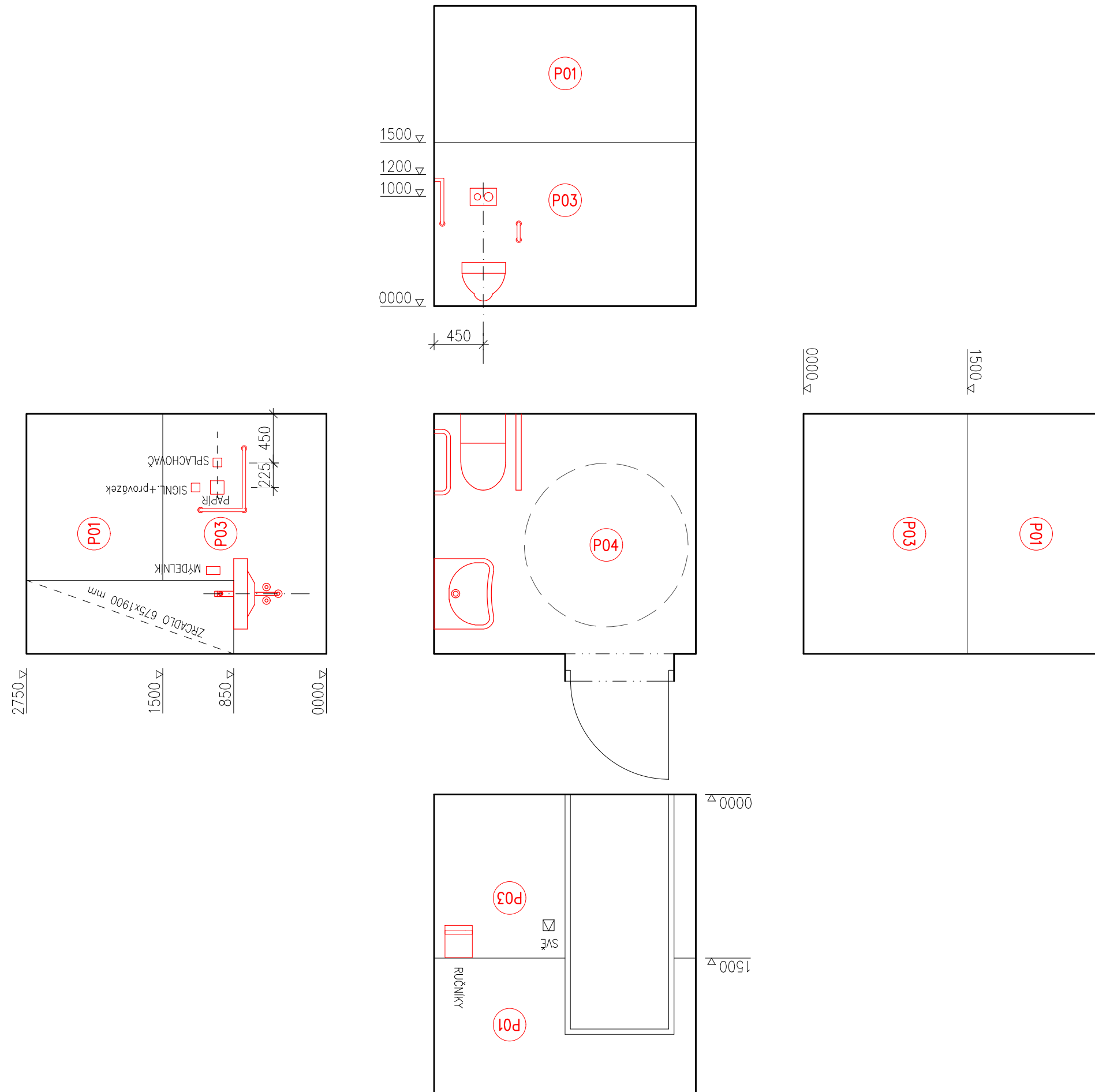

VÝKRES:
BEZBARIÉROVÉ WC A1.22

Č.det.	Měřítko:
23-11	1:40

TYPICKÁ ŠATNA A1.21

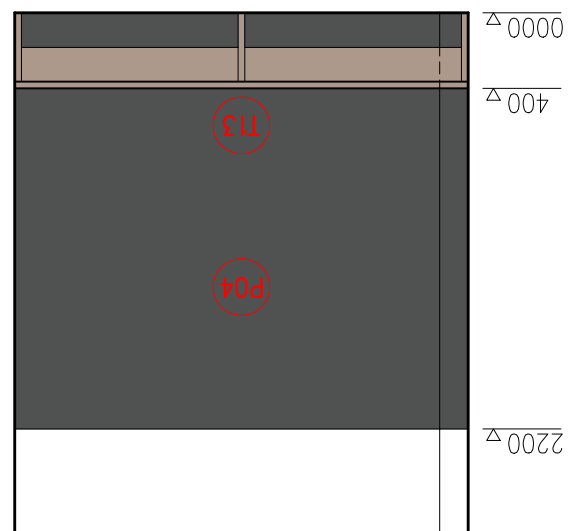
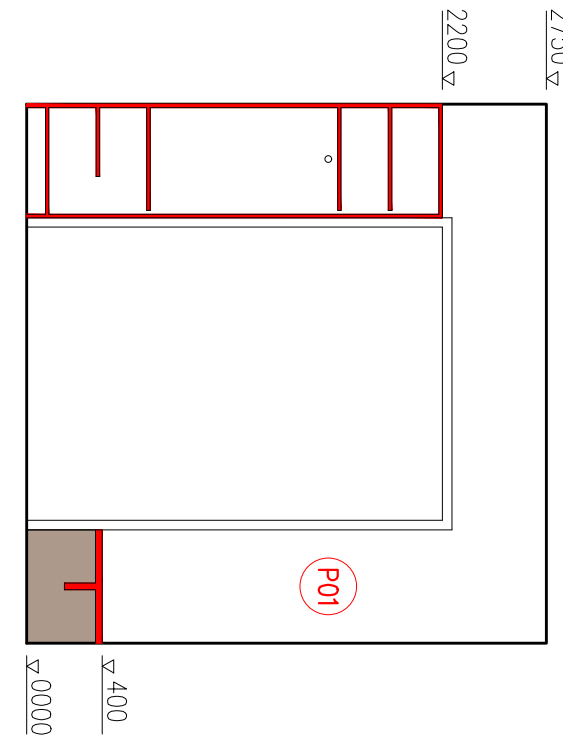
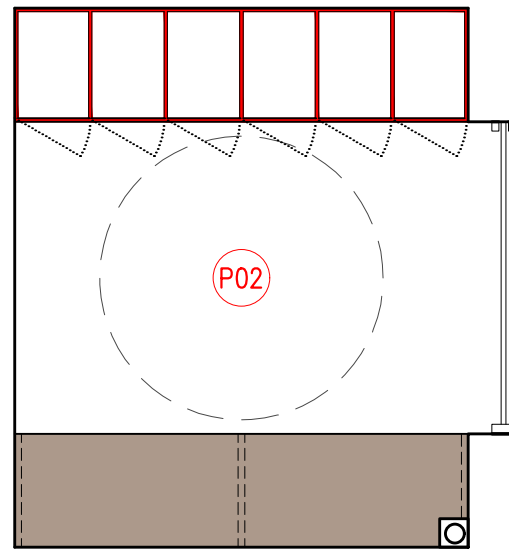
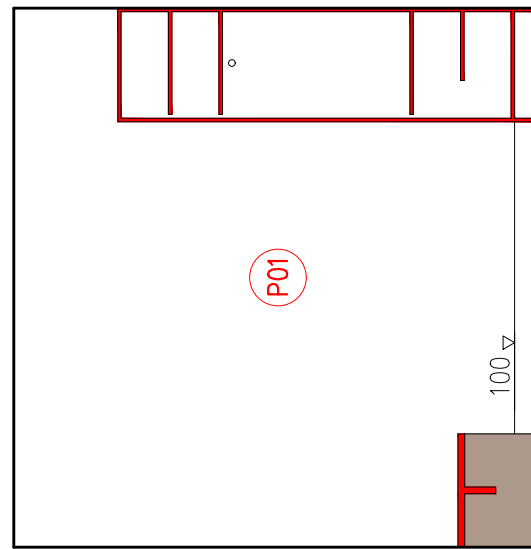
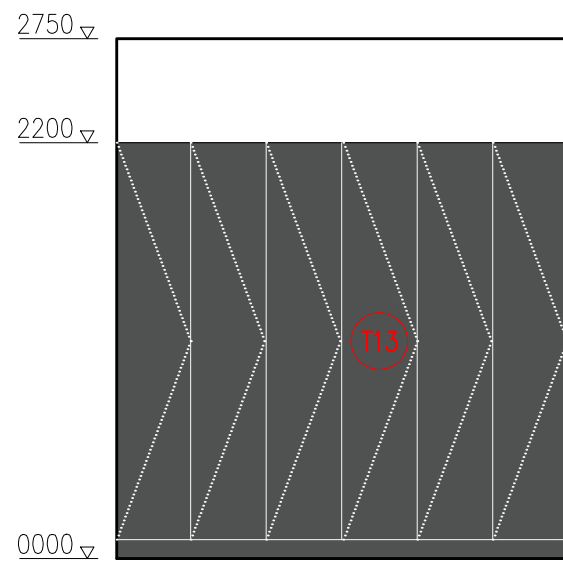

KUCHYŇKA U DENNÍ MÍSTNOSTI A2.04

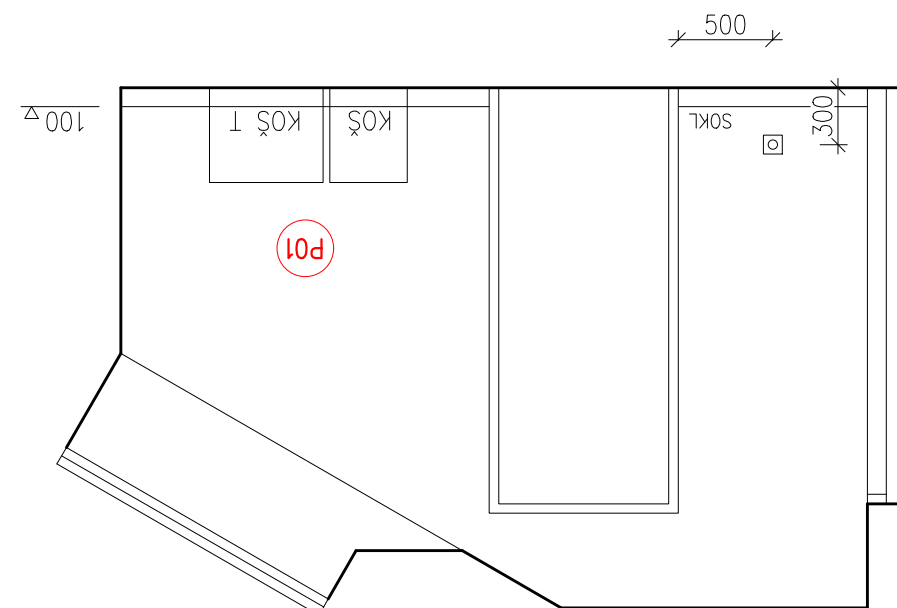
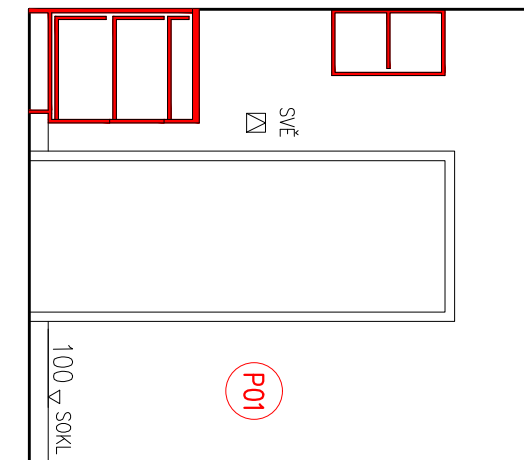
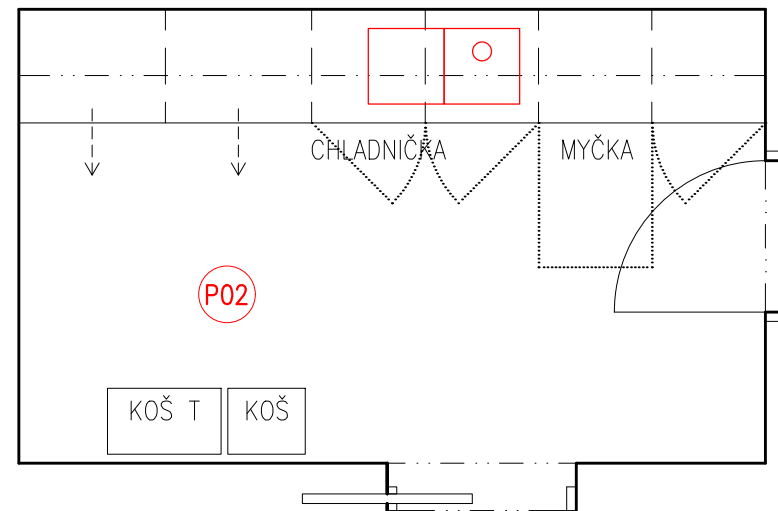
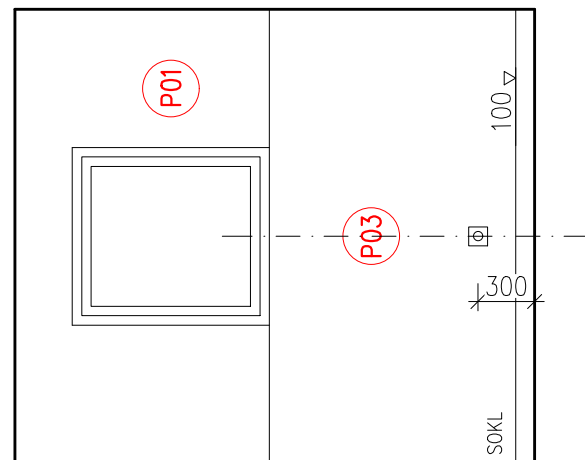
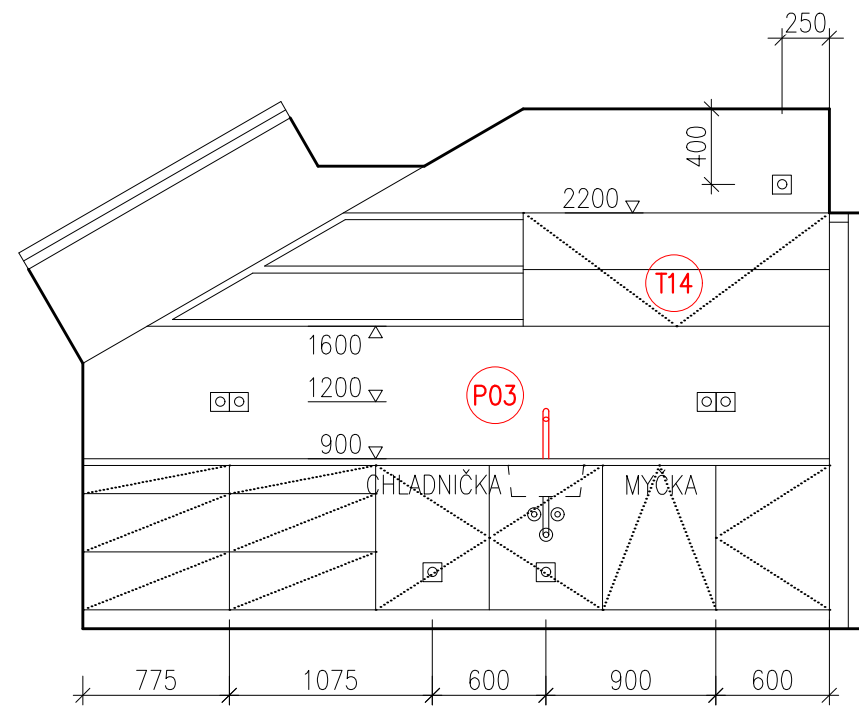

KOUPELNA A ŠATNA PERSONÁLU A2.07, A2.08

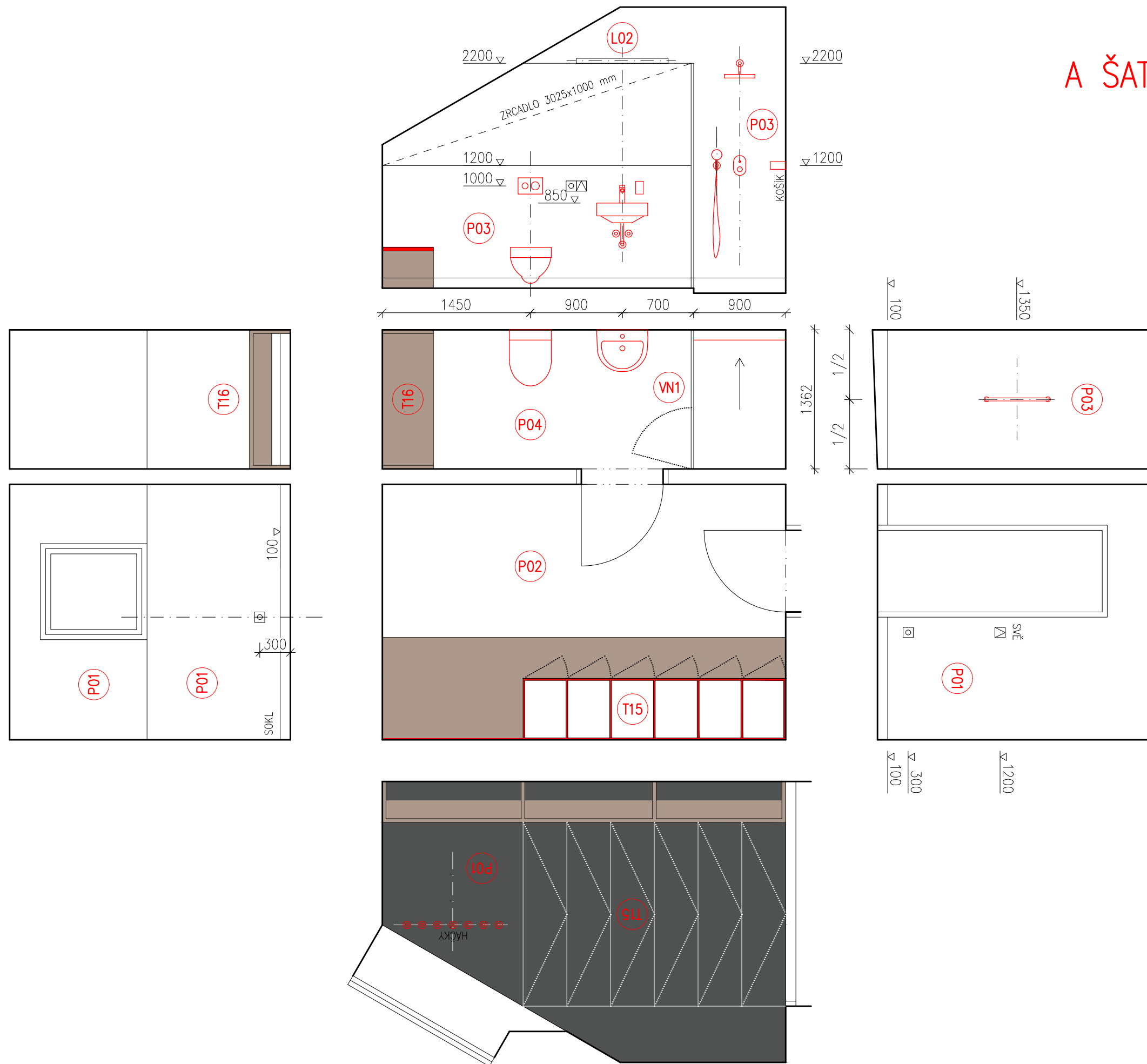

VÝKRES:
KOUPELNA A ŠATNA PERSONÁLU A2.07, A2.08

Č.det. 23-14
Měřítko: 1:40

SKLAD GASTRO NÁDOB A1.23

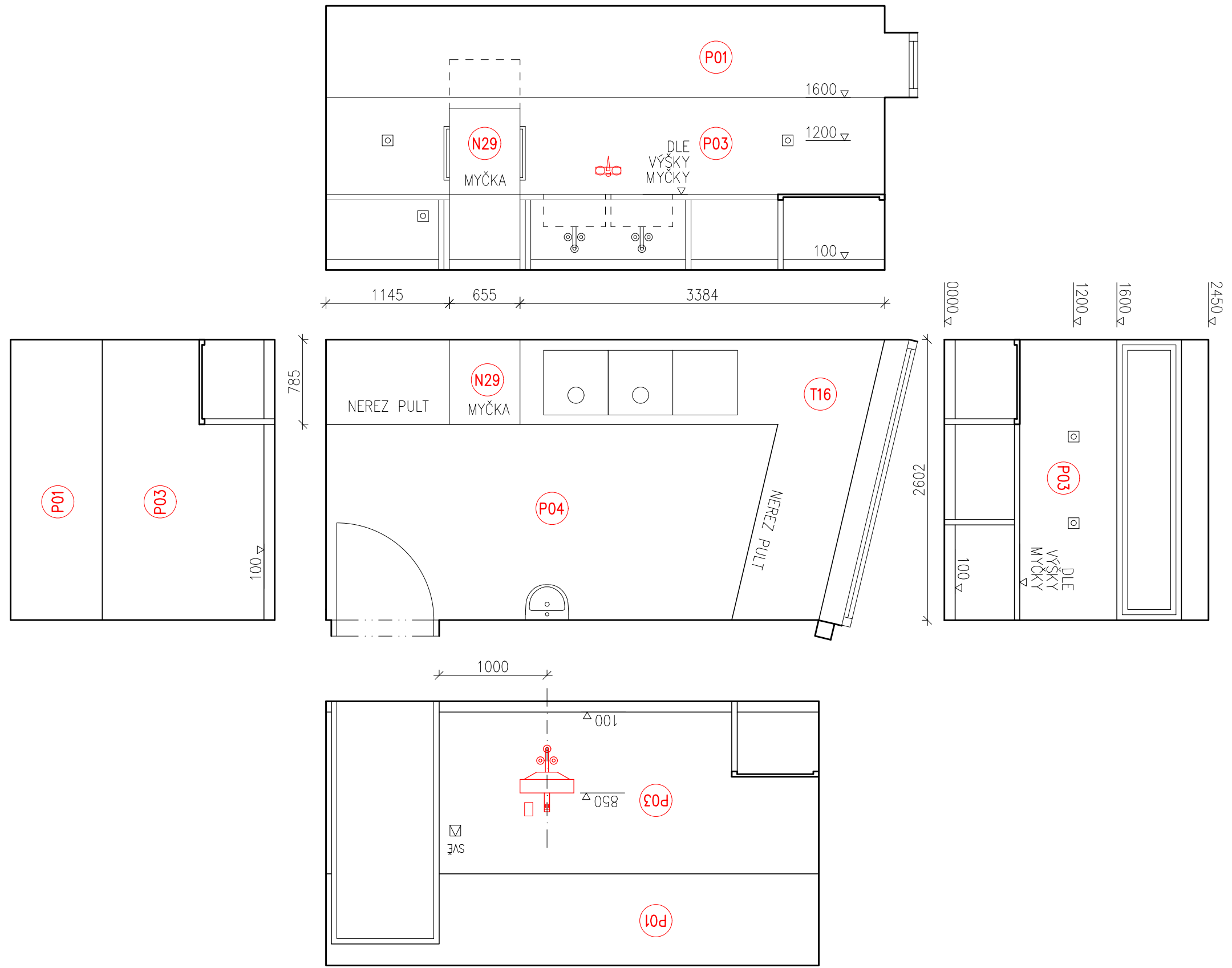

TYPICKÝ VESTIBUL B1.02

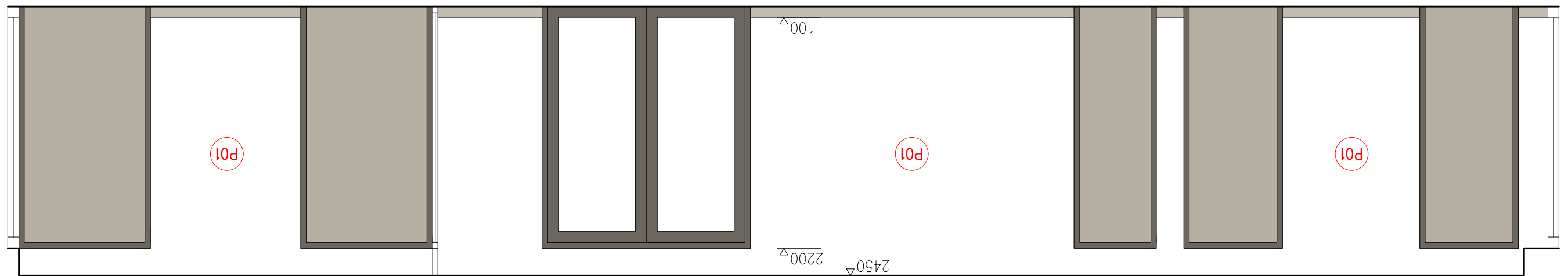
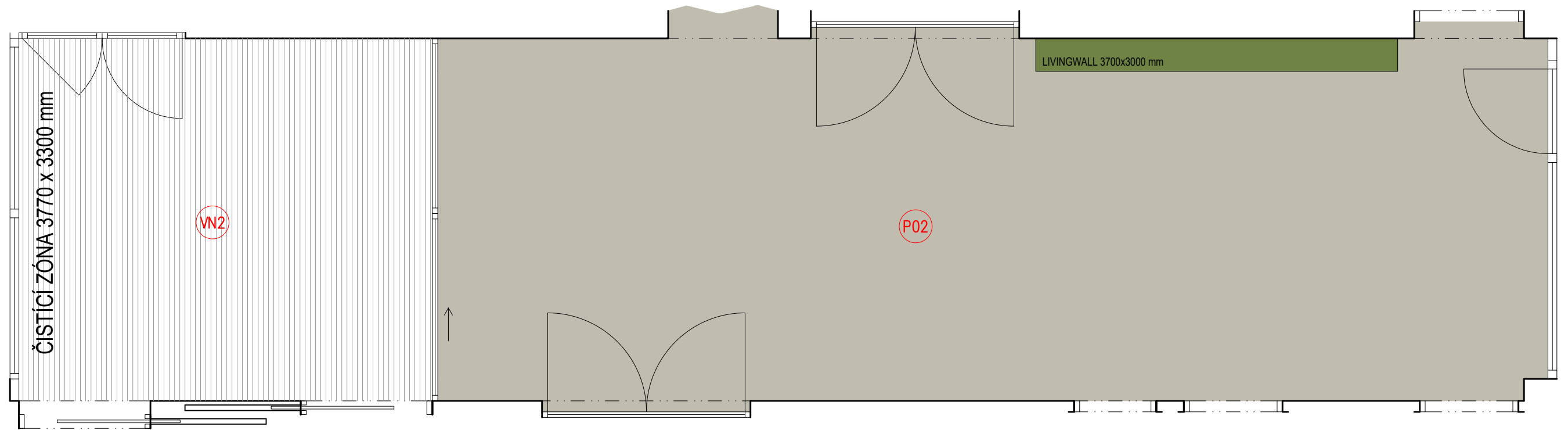
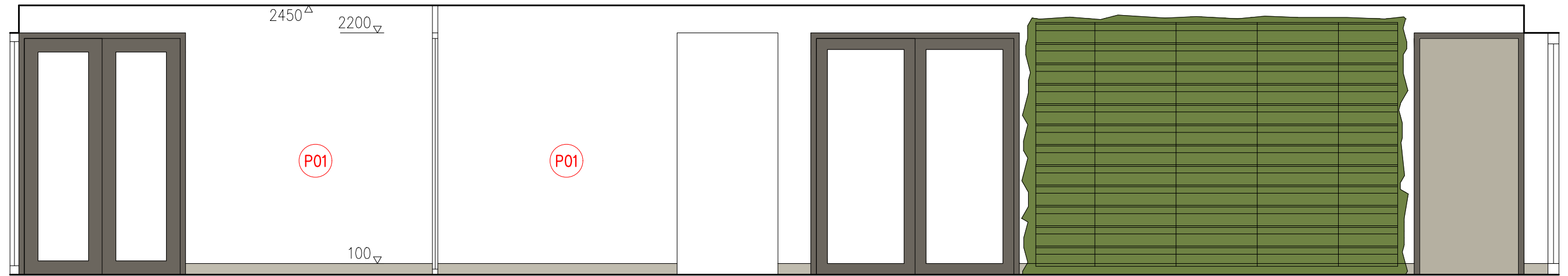

TYPICKÝ SPÁROŘEZ BEDNĚNÍ
STROPU VESTIBULU PRO
POHLEDOVÝ BETON
B1.02

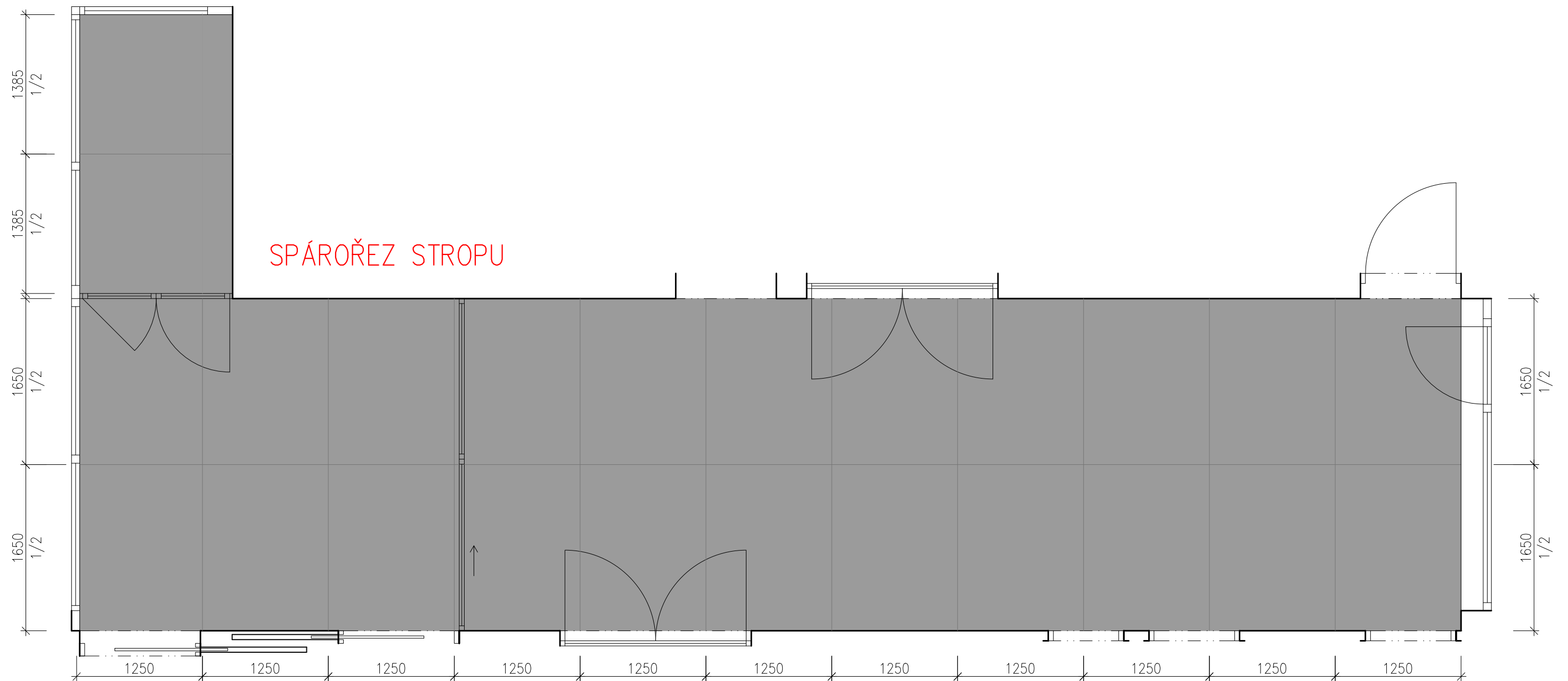

POZNÁMKA:

- zobrazen jen strop v objektu B
- v objektu A bude strop řešen obdobně